

HYPERPRO

LOWERING KIT / VERLAGINGSSET

for

SUZUKI SV 650

Models '03>

LK-SU06-012-50 PART LIST

PR121620 - Pull rod/ trekstang	2
SL144710 - Stroke limiter/ slagbeperker	1
SL254711 - Stroke limiter/ slagbeperker	1
-	-

ALL IDEAS, DESIGNS ARRANGEMENTS AND PLANS INDICATED OR REPRESENTED BY THIS DRAWING ARE OWNED BY HYPERPRO AND WERE CREATED, EVOLVED AND DEVELOPED FOR USE ON AND IN CONNECTION WITH THE SPECIFIC PROJECT. NONE SUCH IDEAS, DESIGNS, ARRANGEMENTS OR PLANS SHALL BE USED BY OR DISCLOSED TO ANY PERSON, FIRM OR CORPORATION FOR ANY PURPOSE WHATSOEVER WITHOUT THE WRITTEN PERMISSION OF HYPERPRO.

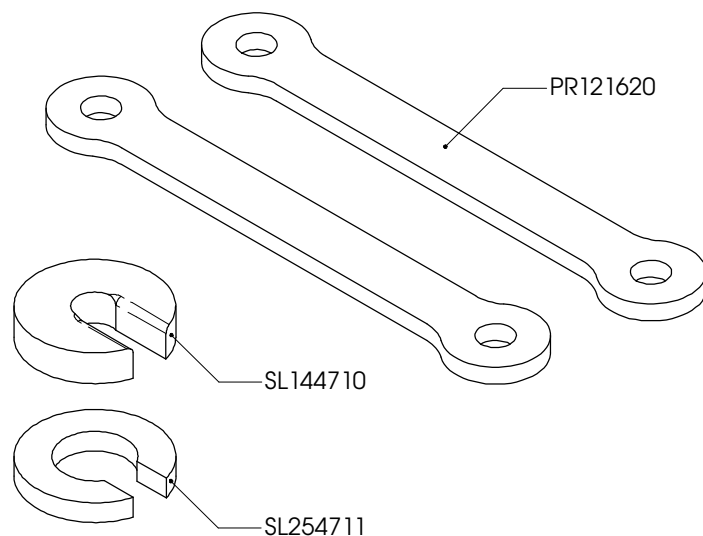

Inbouw handleiding

VOORZIJD

De vorkpoten maximaal 5 mm door de bovenste kroonplaat heen steken. De veer-voorspanning minimaal zetten (tegen de klok in draaien). De voorspanbussen met 15 mm inkorten. Luchtkamer naar 50 mm brengen (gemeten met de poten ingedrukt, met veer, zonder bus).

ACHTERZIJD

De bestaande trekstangen vervangen door de HYPERPRO trekstangen. De slagbepers onder het aanslagrubber van de achterschokbreker plaatsen. Het achterwiel eerst belasten voordat de link vastgezet word.

LET OP! DE LENGTE VAN DE ZIJSTANDAARD MOET 30-35mm INGEKORT WORDEN. VERWIJDER DE MIDDENBOK.

Instruction manual

FRONT

Mount the fork legs max 5mm through the triple clamp. Turn the preload adjuster to minimum preload (counter clockwise). Shorten the spacers with 15 mm. Reduce the air chamber to 50 mm. (This is measured with the forklegs pressed down with spring without spacer).

REAR

Replace the original pull rods with the HYPERPRO lowering pull rods. Put the stroke limiters under the bump rubber of the rear shock. Put some pressure on the rear wheel before tightening the link.

WARNING! SHORTEN THE SIDE-STAND 30-35mm. REMOVE THE CENTER STAND.

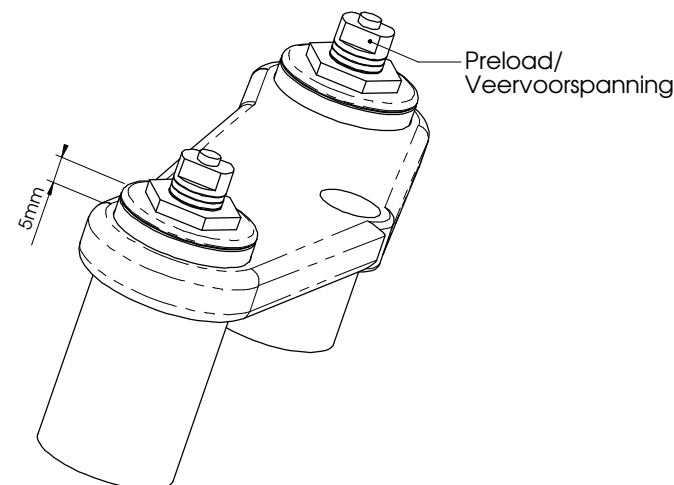

See WWW.HYPERPRO.COM for more info about our products.