

HYPERPRO

LOWERING KIT / VERLAGINGSSET

for

SUZUKI GSXR 1000

Models '05>

LK-SU10-005-30 PART LIST

PR121860 - Pull rods/ trekstangen	2
-	-
-	-
-	-

ALL IDEAS, DESIGNS, ARRANGEMENTS AND PLANS INDICATED OR REPRESENTED BY THIS DRAWING ARE OWNED BY HYPERPRO AND WERE CREATED, EVOLVED AND DEVELOPED FOR USE ON AND IN CONNECTION WITH THE SPECIFIC PROJECT. NONE SUCH IDEAS, DESIGNS, ARRANGEMENTS OR PLANS SHALL BE USED BY OR DISCLOSED TO ANY PERSON, FIRM OR CORPORATION FOR ANY PURPOSE WHATSOEVER WITHOUT THE WRITTEN PERMISSION OF HYPERPRO.

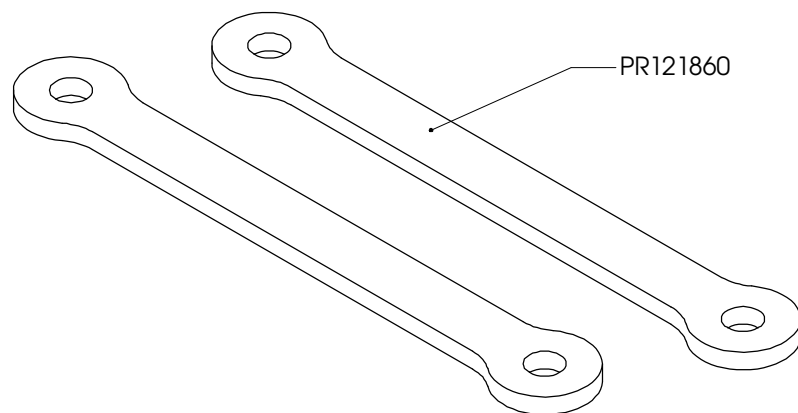

Inbouw handleiding

VOORZIJDJE

De vorkpoten maximaal 18mm door de bovenste kroonplaat heen steken. De veer-voorspanning minimaal zetten (tegen de klok in draaien). De luchtkamer reduceren als de vork wil doorslaan.

ACHTERZIJDJE

Verwijder de originele trekstangen en de achterschokdemper. Verminder de veer-voorspanning met 7mm (tegen de klok in draaien). Monteer de schokdemper terug en de HYPERPRO trekstangen. Het achterwiel eerst belasten voordat de link vastgezet word.

LET OP! DE LENGTE VAN DE ZIJSTANDAARD MOET 10-15mm INGEKORT WORDEN.

Instruction manual

FRONT

Mount the fork legs max 18mm through the triple clamp. Turn the preload adjuster to minimum preload (counter clockwise). Reduce the air chamber if necessary.

REAR

Remove the original pull rods and the shock. Reduce the spring preload by 7mm (counter clockwise). Install the shock and the HYPERPRO lowering pull rods. Put some pressure on the rear wheel before tightening the link.

WARNING! SHORTEN THE SIDE-STAND 10-15mm.

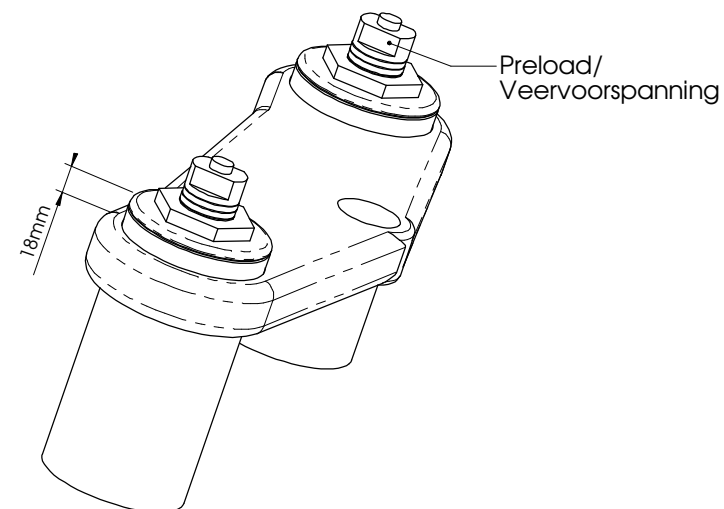

See WWW.HYPERPRO.COM for more info about our products.