

HYPHERPRO

STEERING DAMPER MOUNTING KIT

for

SUZUKI GSX-R 600 / 750 Model '08-'10<

MK-SU06-T011 PART LIST

SD stroke 75	1	M8x35 Button head	1
Tube Clamp TYPE 3	1	M8x40 Button head	1
O-Ring	2	Washer M6 ϕ 12	1
Fork Bracket (MP-FOMK74)	1	Washer M6 ϕ 18	1
Tank Bracket (MP-TAMK64-1)	1	Spacer Type 1	1
Tank Bracket (MP-TAMK64-2)	1	Elec. Resistor (MP-ELEC01)	1
M6x20 Low head	2	-	-
M6x20	2	-	-

ALL IDEAS, DESIGNS ARRANGEMENTS AND PLANS INDICATED OR REPRESENTED BY THIS DRAWING ARE OWNED BY HYPERPRO AND WERE CREATED, EVOLVED AND DEVELOPED FOR USE ON AND IN CONNECTION WITH THE SPECIFIC PROJECT. NONE SUCH IDEAS, DESIGNS, ARRANGEMENTS OR PLANS SHALL BE USED BY OR DISCLOSED TO ANY PERSON, FIRM OR CORPORATION FOR ANY PURPOSE WHATSOEVER WITHOUT THE WRITTEN PERMISSION OF HYPERPRO.

Step 1: remove the original steering damper, install the Hyperpro electrical resistor

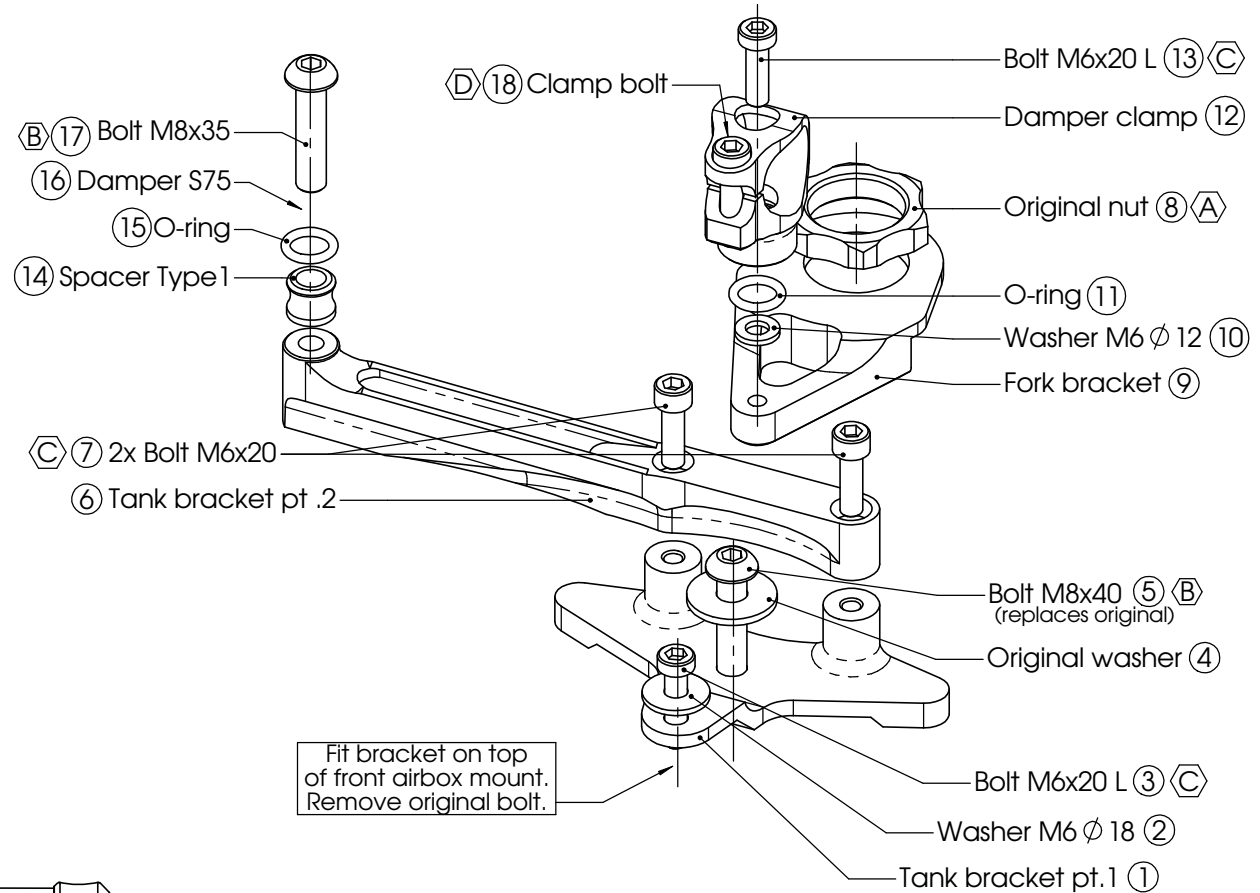
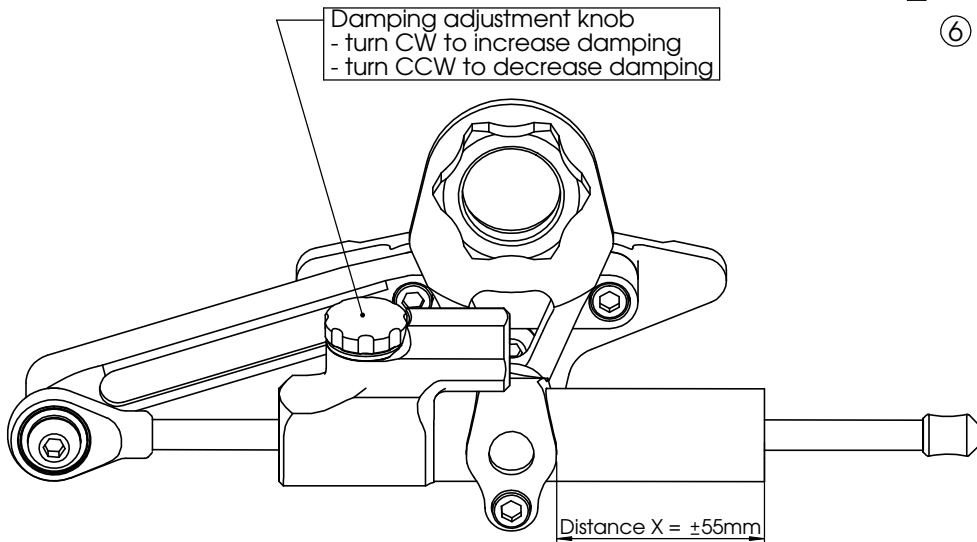
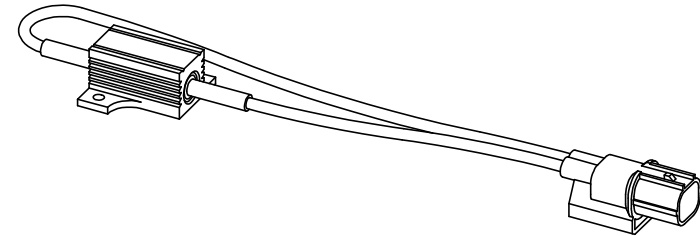

Fit bracket on top of front airbox mount. Remove original bolt.

1
of 2

(A) 55-75Nm / 486-663Lbs.In / 40-55Lbs.Ft	(C) 5-9Nm / 44-80Lbs.In / 4.0-6.4Lbs.Ft
(B) 14-17Nm / 124-150Lbs.In / 10.3-12.5Lbs.Ft	(D) 6Nm / 53Lbs.In / 4.4Lbs.Ft

HYPERPRO

STEERING DAMPER MOUNTING KIT

for

SUZUKI GSX-R 600 / 750 Model '08-'10<

MK-SU06-T011 INSTALLATION INSTRUCTIONS

In general:

HYPERPRO can not be held responsible in any way for any form of physical, material, financial or other damage arising from use, assembly or overhaul of HYPERPRO products. HYPERPRO reserves the right to make changes without prior notice.

This product is ONLY TO BE INSTALLED BY A PROFESSIONAL MECHANIC.

This product is only to be used for the motorcycle brand, model and year stated specifically on top of the pages of this manual.

DO NOT attempt to install this product on motorcycles from any different brand, model and/or year than stated on the pages of this manual.

DO NOT use this kit for cars, boats, jet-skies, snowmobiles, ATV's, aircraft, hovercrafts or any other vehicle and/or purpose.

HYPERPRO steering dampers are FOR RACE USE ONLY, NOT FOR HIGHWAY USE!

Before installation:

- Please read the entire manual carefully before starting the installation!
- Check if you have all the tools required. Good tools are a must.
- Protect your bike at the most important places in and around the work area (e.g. tank, fairing, frame, etc.), with a blanket, towel or similar.

During installation:

- Check all operations and parts carefully before, during and after performing each step.
- Clean all surfaces that are required for fitting parts together or for applying self adhesives or loctite, thoroughly with contact cleaner or another degreaser, unless otherwise stated.
- Be careful not to damage or scratch any part of your bike.
- ALWAYS work relaxed and concentrated!! It is very easy to damage something or make a mistake.

After installation:

- Check and make sure that there is no contact between any part of the steering damper kit and any part of the motorcycle. The kit should not hit anything. Steering movement should not be limited by the steering damper. If the steering movement is limited, adjust the position of the tube in the clamp until steering movement is normal again. Do not forget to tighten the clamp bolt again!
- ALWAYS check the steering movement and feeling before each ride!
- FIRST RIDES: Start with the damper turned fully open (turn adjuster knob fully counter clockwise). Start adjusting in between rides with steps of MAX. 2 CLICKS (0.25 TURN) EACH TIME, until the damper is working satisfactory for your riding style.
- NEVER USE MAXIMUM SETTING, ALWAYS OPEN AT LEAST 2 CLICKS (0.25 TURN).

- WARNING ! DAMPER HAS AN ACTIVE / SPEEDSENSITIVE DAMPING SYSTEM;
 - Steering with NORMAL MOVEMENT should be FREE !!
 - Steering with FAST MOVEMENT should be CONTROLLED BY DAMPER !!
- HYPERPRO uses a special seal to reduce friction. The seal uses an oil film to work properly. It is normal that some oil can appear on the pistonrod.
- Damper works with oil: DAMPING CAN BE HARDER AT LOWER TEMPERATURES!

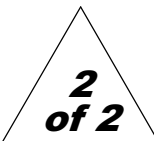

Step 1: remove the original steering damper, install the Hyperpro electrical resistor

Step 2: install tank bracket part 1

Install the tank bracket using:

- Tank bracket pt.1 (1)
- Washer M6 Ø18 (2)
- Bolt M6x20 Low head (3)
- Bolt M8x40 (5)

Raise the tank as described in the Owner's Manual: Remove the seat and all other parts necessary to raise the tank. Loosen and remove the front tank mount bolt. Raise the tank and support it using block of wood.

Loosen and remove the front airbox bolt. Place the Hyperpro tank bracket pt.1 (1) on top of the airbox mount and use the supplied washer (2) and M6x20 bolt (3) to tighten. Tighten the bolt with a torque of approx. 5-9Nm/44-80Lbs.In/4.0-6.4Lbs.Ft.

Lower and re-tighten the tank, seat and panels in the opposite order. Replace the front mounting bolt with the supplied M8x40 bolt (5) and use the original washer (4). Tighten the bolt with a torque of approx. 14-17Nm/124-150Lbs.In/10.3-12.5Lbs.Ft.

Step 3: install tank bracket part 2

Complete the tank bracket using:

- Tank bracket pt.2 (6)
- 2x Bolt M6x20 (7)

Put the assembly together as shown on page 1: Fit Tank brackets pt.2 (6) to Tank bracket pt.1 using the 2 supplied M6 bolts (7). Tighten the bolts with a torque of approx. 5-9Nm/44-80Lbs.In/4.0-6.4Lbs.Ft.

Step 4: install the fork bracket

Install and assemble the fork bracket using:

- Fork bracket (9)
- Washer M6 Ø12 (10)
- O-ring (11)
- Clamp Type 3 (12)
- Bolt M6x20 low-head (13)

Loosen and remove the steering stem nut (8). Remove standard washer. Place the fork bracket over the thread against the top triple clamp. DO NOT use the original washer. Replace the nut and tighten carefully with a torque of approx. 55-75Nm/486-663Lbs.In/40-55Lbs.Ft.

Fit the damper clamp (12) to the fork bracket using the washer (10) + O-ring (11) underneath and the bolt (13) to fix. Tighten the bolt with a torque of approx. 5-9Nm/44-80Lbs.In/4.0-6.4Lbs.Ft.

Step 5: install the steering damper

Install the steering damper using:

- Spacer (14)
- 1x O-ring (15)
- Steering damper, stroke 75 (16)
- Bolt M8x25 button head (17)

Ensure that the clamp bolt of the Tube clamp (18) is pointing to the tank. Shove the damper (16), with the end-knob first, through the clamp until the ball joint can be fitted to the tank bracket. Use the spacer (14) & O-ring (15) underneath and tighten the M8 bolt (17) with a torque of approx. 14-17Nm/124-150Lbs.In/10.3-12.5Lbs.Ft. Position the damper body in the clamp until distance "X" is reached as shown on page 1, then tighten the M6 clamp bolt (18) with a torque of approx. 6Nm/53Lbs.In/4.4Lbs.Ft.

Check if the damper is level horizontally and aligned to the bike.

Check if the damper does not touch anything (e.g. tank) when steering from left to right.

Check if the bike can make it's full steering angle from left to right.